

SERIE ARMARIOS FRIGORÍFICOS



ASESORAMIENTO
PERSONALIZADO

INGENIERÍA
Y PROYECTOS

SOLUCIONES
LLAVE EN MANO

EQUIPAMIENTO
INTEGRAL

ATENCIÓN
AL CLIENTE



Empresa Homologada por la
Dirección General del Patrimonio del Estado

mobiliar@mobiliar.es
www.mobiliar.es
902 365 064

SERIE SERIES	DESCRIPCIÓN DESCRIPTION	PAG.
NACIONAL 400/900	Armario de refrigeración Euronorma 600x400 Euronorm 600x400 reach in refrigerator	120
AP 400/900	Armario de refrigeración pescado Euronorma 600x400 Euronorm 600x400 reach in fish refrigerator	122
NACIONAL 400/900	Armario de refrigeración pastelería Euronorma 600x400 Euronorm 600x400 pastry reach in refrigerator	124
NACIONAL 500/1000	Armario de refrigeración y congelación mixto y dep. pescado Bottom mounted reach in refrigerator and freezer	126
AN 500/1000 SC	Armario secadero de embutidos Seasoning refrigerator	136
AN 1600	Armario refrigeración Bottom mounted refrigerator	138
A 800	Armario de refrigeración Euronorma 600x400 Euronorm 600x400 reach in refrigerator	140
AGN 300/600	Armario de refrigeración y congelación GN 1/1 GN 1/1 reach in refrigerator and freezer	142
AGB 600/1300 700/1400	Armario de refrigeración, congelación pescado, pastelería y expositor GN 2/1 GN 2/1 Refrigerator, freezer, fish, pastry and glass door reach in	148
AGB 900	Armario de refrigeración y congelación 800x600 heladería pastelería Reach in Euronorm pastry ice cream 800x600 Refrigerator and freezer	164
FC	Armario de fermentación Retarder proofer cabinet	164
AC	Armario catering refrigeración y congelación 600 L. Catering reach in refrigerator and freezer 600 l.	166
RIC	Armario para carros GN 2/1, 600x400, 800x600, 1300/2700 l. GN 2/1, 600x400, 800x600, 1300/2700 l. Roll-in	167

3.

ARMARIOS REACH INS



Mejora de la clasificación energética a tipo A, y B. Better energetic class , A and B.

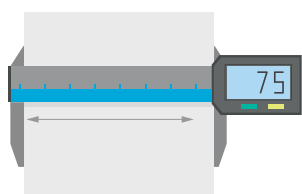

Espesor de aislamiento 75 mm.
Insulation thickness of 75 mm.



Refrigerante natural R-290 GWP=0. FGAS de serie en modelos BT, opcional en refrigeración. Natural refrigerant R-290 GWP =0. FGAS. Standard BT models, optional refrigerated models.



Clase climática 5 Amb 40°C/40% HR. Equipos tropicalizados. [Modelos refrigeración] Climate class 5. Amb. 40°C/40% HR. Tropicalized equipment. [Refrigerated models]



Costados embutidos y parrillas reforzadas. Stamped inner sides and reinforced wire shelves.



Nuevo Controlador digital táctil e intuitivo IP 65. New digital control easy and intuitive-touch screen IP65 protection.



Cuadro elevable con fácil acceso al grupo frigorífico. Lift-up control panel for easy access to condenser unit.



Sistema Monoblock para maximizar capacidad interior. Monoblock system to maximize internal capacity.



Puertas con tirador de doble agarre y burlete plano fácilmente desmontable "cleanless". Double handle doors and flat gasket easily removable "cleanless".



Desagüe interno y radio sanitario conforme a normativa NSF-7. Internal drain and rounded corner according NSF-7 standard.

Nueva línea de armarios

New range of reach ins



Nueva línea eficiente de armarios Monoblock de refrigeración y congelación mejoradas en diseño, robustez y fiabilidad, manteniendo la misma capacidad y cumpliendo con los altos estándares de calidad.

New range of reach ins and freezers improved in design, robustness and maintaining the same capacity and high standards of quality and reliability.

AGB 701

3.

ARMARIO DE REFRIGERACIÓN EURONORMA 600x400 EURONORM 600X400 REACH IN REFRIGERATOR

3



AN 401 T/F

MOD.



MOD.	Acero inox Stainless Steel [EXT/INT]	Espesor Thickness [MM]	Capacidad Capacity [L]	Nº puertas Doors	Nº Parrillas/J. guías Nº Shelves/Slides	Sistema de frío Cooling System	Control digital Digital control	LED	Potencia Power [W]	Potencia frigorífica Cooling capacity [W A -10°C]	Consumo Consumption [kWh/24h]	Clase energética Energy class	Refrigerante Refrigerant
AN 401 T/F	AISI 304	55	395	1	3/3 [600x400]	Ventilado Forced	IP65	✓	420	298	2,15	D	R 134 a
									190	343	1,55	C	R 290
AN 902 T/F	AISI 304	55	895	2	6/6 [600x400]	Ventilado Forced	IP65	✓	510	464	2,70	C	R 134 a
									370	690	1,90	B	R 290
AN 904 T/F	AISI 304	55	895	4	3/3 [600x400]	Ventilado Forced	IP65	✓	510	464	2,70	C	R 134 a
									370	690	1,90	B	R 290
AN 401 BT	AISI 304	55	395	1	3/3 [600x400]	Ventilado Forced	IP65	✓	590	644	5,10	D	R 290
AN 902 BT	AISI 304	55	895	2	3/3 [600x400]	Ventilado Forced	IP65	✓	660	644	9,51	D	R 290

SERIE NACIONAL 400/900L. SERIES



AN 904 T/F

AN 401 T/F

557x775x2060 mm

Temp. -2°C/+8°C
C. Clima. 5



AN 902 T/F

1124x775x2060 mm

Temp. -2°C/+8°C
C. Clima. 5



AN 904 T/F

1124x775x2060 mm

Temp. -2°C/+8°C
C. Clima. 5



AN 401 BT

557x775x2060 mm

Temp. -18°C
C. Clima. 4



AN 902 BT

1124x775x2060 mm

Temp. -18°C
C. Clima. 4



OPCIONAL / OPTIONAL

Parrilla / Wire shelf
[502X26]

Juego de guías / Slides
[GUIA503X04;
GUIA503X24]

- Cerradura / Lock
[506X209; 506X210]

Gas R-290

3.

ARMARIO DE REFRIGERACIÓN PESCADO EURONORMA 600x400 EURONORM 600x400 FISH REACH IN REFRIGERATOR

3

Fotos no contractuales / Non contractual pictures



AP 401 T/F



MOD.

	Acero inox Stainless Steel [EXT/INT]	Espesor Thickness (MM)	Capacidad Capacity (L)	N° puertas Doors	N° contenedores containers	Sistema de frío Cooling System	Control digital Digital control	LED	Potencia Power (W)	Potencia frigorífica Cooling capacity (W A -10°C)	Consumo Consumption (kWh/24h)	Clase energética Energy class	Refrigerante Refrigerant
AP 401 T/F	AISI 304	55	395	1	7	Ventilado Forced air	IP65	✓	420	298	2,15	D	R 134 a
									190	343	1,55	C	R 290
AP 902 T/F	AISI 304	55	895	2	14	Ventilado Forced air	IP65	✓	510	464	2,70	C	R 134 a
									370	690	1,90	B	R 290

SERIE AP 400/900L. SERIES



AP 902 T/F



AP 401 T/F

557x775x2060 mm

Temp. -2°C/+2°C
C. Clima. 5



AP 902 T/F

1124x775x2060 mm

Temp. -2°C/+2°C
C. Clima. 5

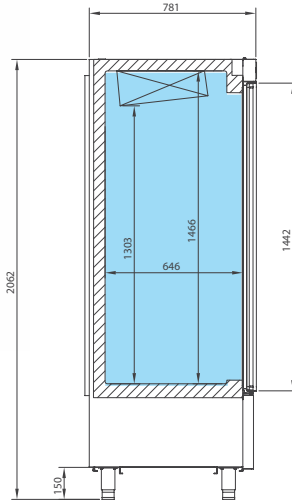

AP 401

OPCIONES OPTIONS

- Contenedor polipropileno / Polypropylene container [501X08]
- Cerradura / Lock [506X209; 506X210]
- Gas R-290

3.

ARMARIO DE REFRIGERACIÓN PASTELERÍA EURONORMA 600x400 EURONORM 600x400 PASTRY REFRIGERATOR REACH IN

3

Fotos no contractuales / Non contractual pictures



AN 401 PAST



MOD.

	Acero inox Stainless Steel (EXT/INT)	Espesor Thickness (MM)	Capacidad Capacity (L)	N° puertas Doors	N° Bandeja/ Juego de guías Trays/ Slides Kit	Sistema de frío Cooling System	Control digital Digital control	LED	Potencia Power (W)	Potencia frigorífica Cooling capacity (W A -10°C)	Consumo Consumption (kWh/24h)	Clase energética Energy class	Refrigerante Refrigerant
--	--	------------------------------	------------------------------	---------------------	--	-----------------------------------	------------------------------------	-----	--------------------------	---	-------------------------------------	----------------------------------	-----------------------------

AN 401 PAST	AISI 304	55	395	1	0/18	Ventilado Forced air	IP65	✓	420 190	298 343	2,15 1,55	D C	R 134 a R 290
AN 902 PAST	AISI 304	55	895	2	0/36	Ventilado Forced air	IP65	✓	510 370	464 690	2,70 1,90	C B	R 134 a R 290

SERIE NACIONAL 400/900L. SERIES



AN 902 PAST



AN 401 PAST

557x775x2060 mm

Temp. -2°C/+8°C
C. Clima. 5



AN 902 PAST

1124x775x2060 mm

Temp. -2°C/+8°C
C. Clima. 5

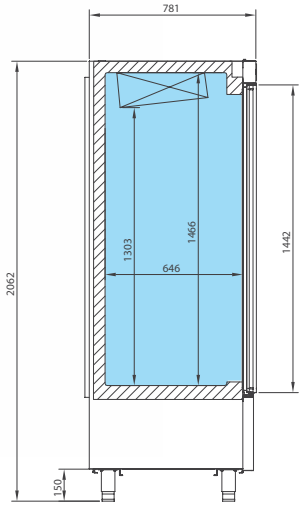

AN 401 PAST

OPCIONES OPTIONS

- **Juego de guías** / Slides [GUIA503X04; GUIA503X24]
- **Bandeja 600x400** / Tray 600x400 [A850P41]
- **Cerradura** / Lock [506X209; 506X210]
- **Gas R-290**

3.

ARMARIO DE REFRIGERACIÓN Y CONGELACIÓN BOTTOM MOUNTED REACH IN REFRIGERATOR AND FREEZER

3



AN 501 T/F

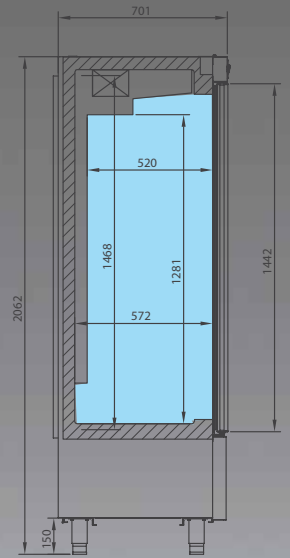

AN 501

MOD.

- Acero inox
Stainless Steel
[EXT/INT]
- Espesor
Thickness
(MM)
- Capacidad
Capacity
(L)
- N° puertas
Doors
- N° Parrillas/J. guías
N° Shelves/Slides
- Sistema de frío
Cooling System
- Control digital
Digital control
- LED
- Potencia
Power
(W)
- Potencia frigorífica
Cooling capacity
(W A -10°C/-30°C)
- Consumo
Consumption
(kWh/24h)
- Clase energética
Energy class
- Refrigerante
Refrigerant

MOD.	Acero inox Stainless Steel [EXT/INT]	Espesor Thickness (MM)	Capacidad Capacity (L)	N° puertas Doors	N° Parrillas/J. guías N° Shelves/Slides	Sistema de frío Cooling System	Control digital Digital control	LED	Potencia Power (W)	Potencia frigorífica Cooling capacity (W A -10°C/-30°C)	Consumo Consumption (kWh/24h)	Clase energética Energy class	Refrigerante Refrigerant
AN 501 T/F	AISI 304	75	500	1	3/3 (530x460)	Ventilado Forced air	IP65	✓	420 190	298 343	2,19 1,45	D C	R 134 a R 290
AN 1002 T/F	AISI 304	75	1110	2	6/6 (530x510)	Ventilado Forced air	IP65	✓	510 370	464 690	3,91 2,53	C B	R 134 a R 290
AN 501 BT	AISI 304	75	500	1	3/3 (530x460)	Ventilado Forced air	IP65	✓	600	644	5,72	D	R 290
AN 1002 BT	AISI 304	75	1110	2	6/6 (530x510)	Ventilado Forced air	IP65	✓	670	644	10,70	D	R 290

SERIE NACIONAL 500/1000L. SERIES

Motoventiladores EC
EC motorfans

Marco de puerta calefactado
Heated door frame

Desescarche por gas caliente
Hot gas defrost system

**Válvula de expansión
termostática**
Thermostatic expansion valve

AN 1002 BT

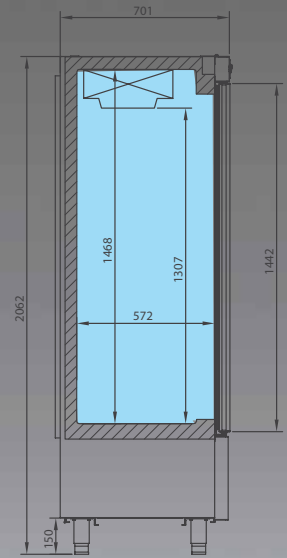

AN 1002

AN 501 T/F

687x700x2060 mm

Temp. -2°C/+8°C
C. Clima 5



AN 501 BT

687x700x2060 mm

Temp. -18°C
C. Clima 4



AN 1002 T/F

1385x700x2060 mm

Temp. -2°C/+8°C
C. Clima 5



AN 1002 BT

1385x700x2060 mm

Temp. -18°C
C. Clima 4



OPCIONAL / OPTIONAL

- Parrilla/ Wire shelf AN 500 [502X04]
- Parrilla/ Wire shelf AN 1000 [502X02]
- Juego de guías/ Slides AN 500 [503X14]; 503X19]
- Juego de guías/ Slides AN 1000 [503X12; 503X17]
- Barra carnicera/ Meat bar set [BCAN]
- Cerradura / Lock [506X209; 506X210]
- Ruedas / Casters [705X16=2; 705X17=2]

3.

ARMARIO DE REFRIGERACIÓN

BOTTOM MOUNTED REFRIGERATOR REACH IN

3

Fotos no contractuales / Non contractual pictures



AN 502 T/F

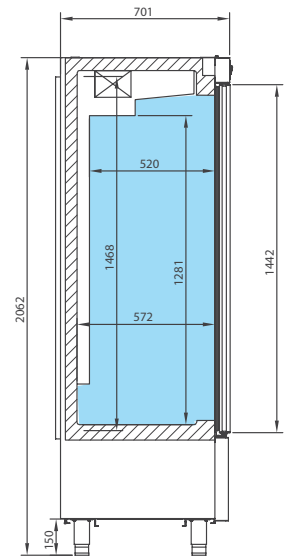

AN

MOD.

	Acero inox Stainless Steel [EXT/INT]	Espesor Thickness (MM)	Capacidad Capacity (L)	N° puertas Doors	N° parrillas / J. Guías Shelves/ slides	Sistema de frío Cooling System	Control digital Digital control	LED	Potencia Power (W)	Potencia frigorífica Cooling capacity [W A -10°C]	Consumo Consumption (kWh/24h)	Clase energética Energy class	Refrigerante Refrigerant
--	--	------------------------------	------------------------------	---------------------	---	-----------------------------------	------------------------------------	-----	--------------------------	---	-------------------------------------	----------------------------------	-----------------------------

AN 502 T/F	AISI 304	55	500	2	3/3 [530x460]	Ventilado Forced air	IP65	✓	420	298	2,19	D	R 134 a
									190	343	1,45	C	R 290
AN 1003 T/F	AISI 304	55	1110	3	6/6 [530x510]	Ventilado Forced air	IP65	✓	510	464	3,91	C	R 134 a
									370	690	2,53	B	R 290
AN 1004 T/F	AISI 304	55	1110	4	6/6 [530x510]	Ventilado Forced air	IP65	✓	510	464	3,91	C	R 134 a
									370	690	2,53	B	R 290

SERIE NACIONAL 500/1000L. SERIES



AN 1003

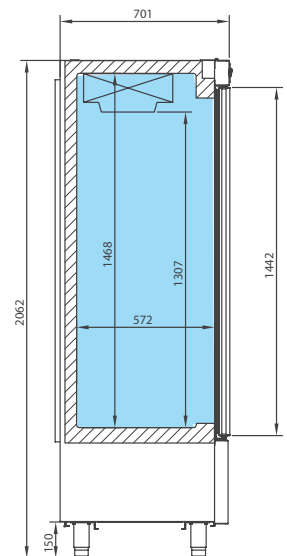

AN 1003

AN 502 T/F

687x700x2060 mm

Temp. -2°C/+8°C
C. Clima 5



AN 1003 T/F

1385x700x2060 mm

Temp. -2°C/+8°C
C. Clima 5



AN 1004 T/F

1385x700x2060 mm

Temp. -2°C/+8°C
C. Clima 5



OPCIONAL / OPTIONAL

- Parrilla / Wire shelf AN 500 [502X04]
- Parrilla / Wire shelf AN 1000 [502X02]
- Juego de guías / Slides AN 500 [503X14]; 503X19]
- Juego de guías / Slides AN 1000 [503X12; 503X17]
- Barra carnicera / Meat bar set [BCAN]
- Cerradura / Lock [506X209; 506X210]

ARMARIO DE CONGELACIÓN

BOTTOM MOUNTED FREEZER REACH IN

Fotos no contractuales / Non contractual pictures



AN 502 BT



AN 502 BT

687x700x2060 mm

Temp. -18°C.
C. Clima 4

AN 1003 BT

1385x700x2060 mm

Temp. -18°C.
C. Clima 4

AN 1004 BT

1385x700x2060 mm

Temp. -18°C.
C. Clima 4

MOD.

	Acero inox Stainless Steel [EXT/INT]	Espesor Thickness [MM]	Capacidad Capacity [L]	N° puertas Doors	N° parrillas / J. Guías Shelves/ slides	Sistema de frío Cooling System	Control digital Digital control	LED	Potencia Power [W]	Potencia frigorífica Cooling capacity [W A -30°C]	Consumo Consumption [kWh/24h]	Clase energética Energy class	Refrigerante Refrigerant
--	--	------------------------------	------------------------------	---------------------	---	-----------------------------------	------------------------------------	-----	--------------------------	---	-------------------------------------	----------------------------------	-----------------------------

AN 502 BT	AISI 304	55	910	2	3/3 [530x460]	Ventilado Forced air	IP65	✓	600	644	5,72	D	R 290
AN 1003 BT	AISI 304	55	1110	3	6/6 [530x510]	Ventilado Forced air	IP65	✓	670	644	10,70	D	R 290
AN 1004 BT	AISI 304	55	1110	4	6/6 [530x510]	Ventilado Forced air	IP65	✓	670	644	10,70	D	R 290

SERIE NACIONAL 500/1000L. SERIES



AN 502 MX

AN 502 MX

687x700x2060 mm

Temp. -2°C/+8°C
-18°C

C. Clima 4



AN 1002 MX

1385x700x2060 mm

Temp. -2°C/+8°C
-18°C







C. Clima 4



OPCIONAL / OPTIONAL

- **Parrilla** / Wire shelf AN 500 [502X04]
- **Parrilla** / Wire shelf AN 1000 [502X02]
- **Juego de guías** / Slides AN 500 [503X14]; 503X19]
- **Juego de guías** / Slides AN 1000 [503X12; 503X17]
- **Barra carnicera** / Meat bar set [BCAN]
- **Cerradura** / Lock [506X209; 506X210]

MOD.

	 Capacidad Capacity (L)	 N° puertas Doors	 N° parrillas / J. Guías Shelves / slides	 Potencia Power (W)	 Potencia frigorífica Cooling capacity (W A -10°C)	 Consumo Consumption (kWh/24h)	 Refrigerante Refrigerant
AN 502 MX	240/240	2	3/3 [530x460]	920	258	4,84	R 134 a R 290
AN 1002 MX	540/540	2	6/6 [530x510]	1440	452	7,91	R 134 a R 290

3.

ARMARIO DE REFRIGERACIÓN DEPARTAMENTO PESCADO O BAJA TEMPERATURA

BOTTOM MOUNTED FISH OR FREEZING COMPARTMENT REACH IN

3

Fotos no contractuales / Non contractual pictures



ANDP 1003



De serie: 3 contenedores de polipropileno en departamento de pescado

Standard: 3 polypropylene containers in fish department

MOD.

	Acero inox Stainless Steel [EXT/INT]	Espesor Thickness [MM]	Capacidad Capacity [L]	N° puertas Doors	N°Contenedores/ parrillas Containers/ Shelves	Sistema de frío Cooling System	Control digital Digital control	LED	Potencia Power [W]	Potencia frigorífica Cooling capacity [W A -10/ -30°C]	Consumo Consumption [kWh/24h]	Refrigerante Refrigerant
--	--	------------------------------	------------------------------	---------------------	--	-----------------------------------	------------------------------------	-----	--------------------------	--	-------------------------------------	-----------------------------

ANDP 1003 TF/G	AISI 304	55	245/855	3	3/4	Ventilado/ Estático Forced air / Static	IP 65	✓	640	604	4,43	R 134 a
ANDP 1004 TF/G	AISI 304	55	245/855	4	3/4	Ventilado/ Estático Forced air / Static	IP 65	✓	640	604	4,43	R 134 a
ANDBT 1003 TF	AISI 304	55	245/855	3	0/4	Ventilado Forced air	IP 65	✓	840	464 / 445	5,53	R 134 a R 290
ANDBT 1004 TF	AISI 304	55	245/855	4	0/4	Ventilado Forced air	IP 65	✓	840	464 / 445	5,53	R 134 a R 290

SERIE NACIONAL 500/1000L. SERIES



ANDBT 1004 TF

ANDP 1003 TF/G

687x700x2060 mm

Temp. -2°C/+8°C
-2°C/+2°C
C. Clima 5



ANDP 1004 TF/G

1385x700x2060 mm

Temp. -2°C/+8°C
-2°C/+2°C
C. Clima 5



ANDBT 1003 TF

687x700x2060 mm

Temp. -2°C/+8°C
-18°C
C. Clima 4



ANDBT 1004 TF

1385x700x2060 mm

Temp. -2°C/+8°C
-18°C
C. Clima 4



OPCIONAL / OPTIONAL

- Parrilla / Wire shelf AN 1000 [502X02]
- Juego de guías / Slides AN 1000 [503X12; 503X17]
- Barra carnicera / Meat bar set [BCAN]
- Cerradura / Lock [506X209; 506X210]

3.

ARMARIO EXPOSITOR REFRIGERACIÓN Y CONGELACIÓN BOTTOM MOUNTED REFRIGERATOR AND FREEZER GLASS DOOR REACH IN

3

Fotos no contractuales / Non contractual pictures



AEX 500 T/F

Doble acristalamiento [4-27-4]
Double pane glass [4-27-4]

MOD.	Acero inox Stainless Steel [EXT/INT]	Espesor Thickness (MM)	Capacidad Capacity (L)	Nº puertas Doors	Nº parrillas Shelves	Sistema de frío Cooling System	Control digital Digital control	LED	Potencia Power (W)	Potencia frigorífica Cooling capacity (W A -10°C/-30°C)	Consumo Consumption (kWh/24h)	Refrigerante Refrigerant
AEX 500 T/F	AISI 304	55	500	1	4/4 (530x460)	Ventilado Forced air	IP 65	✓	530	464	3,28	R 134 a
AEX1000 T/F	AISI 304	55	1110	2	8/8 (530x510)	Ventilado Forced air	IP 65	✓	830	684	5,86	R 134 a
AEX 1600 T/F	AISI 304	55	1730	3	12/12 (530x510)	Ventilado Forced air	IP 65	✓	1050	792	7,33	R 134 a
AN 501 BT CR	AISI 304	55	500	1	4/4 (530x460)	Ventilado Forced air	IP 65	✓	645	645	8,60	R 290
AN 1002 BT CR	AISI 304	55	1110	2	8/8 (530x510)	Ventilado Forced air	IP 65	✓	885	907	16,05	R 290

SERIE NACIONAL 500/1000L. SERIES



AN 1002 BT CR

Triple acristalamiento [4-12-3-12-4]
Triple pane glass [4-12-3-12-4]

OPCIONAL / OPTIONAL

- **Parrilla doble tupida** / Dense wire shelf AN 500 [502X90]
- **Parrilla doble tupida** / Dense wire shelf AN 1000 [502X89]
- **Juego de guías** / Slides AN 500 [503X14]; 503X19
- **Juego de guías** / Slides AN 1000 [503X12; 503X17]
- **Barra carnicera** / Meat bar set [BCAN]
- **Cerradura** / Lock [506X209; 506X210]

AEX 500 T/F

687x700x2060 mm

Temp. +2°C/+6°C
C. Clima 4



AEX 1000 T/F

1385x700x2060 mm

Temp. +2°C/+6°C
C. Clima 4



AEX 1600 T/F

1385x700x2060 mm

Temp. +2°C/+6°C
C. Clima 4



AN 501 BT CR

687x700x2060 mm

Temp. -18°C
C. Clima 4



AN 1002 BT CR

1385x700x2060 mm

Temp. -18°C
C. Clima 4



ARMARIO SECADERO DE EMBUTIDOS

SEASONING REFRIGERATOR

3

Fotos no contractuales / Non contractual pictures



AN 501 SC

MOD.

- 
Acero inox
Stainless Steel
[EXT/INT]
- 
Espesor
Thickness
[MM]
- 
Capacidad
Capacity
[L]
- 
Nº puertas
Doors
- 
Barra carnicera
Bars for meat set
- 
Sistema de frío
Cooling System
- 
Control digital
Digital control
- 
LED
- 
Potencia
Power
[W]
- 
Consumo
Consumption
[kWh/24h]
- 
Refrigerante
Refrigerant

AN 501 SC	AISI 304	55	500	1	3	Ventilado Forced air	IP 65	✓	1250	4,80	R 134 a
AN 1002 SC	AISI 304	55	1110	2	6	Ventilado Forced air	IP 65	✓	1670	6,41	R 134 a

SERIE AN 500/1000 L. SERIES



AN 1002 SC

- **Ciclo de secado discontinuo**
- Cycle of discontinuous drying
- **25 Kg por puerta**
- 25 Kg per door
- **Producción 2-3 días aprox.**
- 2-3 days production aprox.

AN 501 SC

687x700x2060 mm

Temp. +4°C/+16°C
C. Clima 4



AN 1002 SC

1385x700x2060 mm

Temp. +4°C/+16°C
C. Clima 4

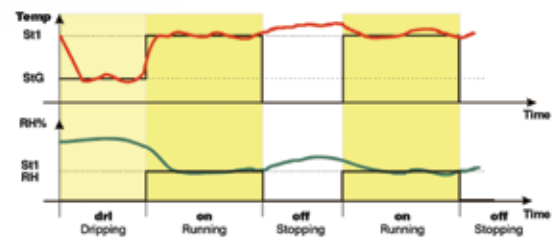

OPCIONAL / OPTIONAL

- **Juego de guías** / Slides AN 500 [503X14]; 503X19]
- **Juego de guías** / Slides AN 1000 [503X12; 503X17]
- **Puerta de cristal** / Glass door [PUE17DGAEX-PUE17IGAEX]
- **Barra carnicera** / Meat bar set [BCSEC3]-[BCAN]
- **Cerradura** / Lock [506X209; 506X210]

ARMARIO REFRIGERACIÓN

BOTTOM MOUNTED REFRIGERATOR

Fotos no contractuales / Non contractual pictures



AN 1606 T/F

MOD.

	Acero inox Stainless Steel [EXT/INT]	Espesor Thickness [MM]	Capacidad Capacity [L]	N° puertas Doors	N° parrillas Shelves	Sistema de frío Cooling System	Control digital Digital control	LED	Potencia Power [W]	Potencia frigorífica Cooling capacity [W A -10°C]	Consumo Consumption [kWh/24h]	Clase energética Energy class	Refrigerante Refrigerant
AN 1603 T/F	AISI 304	55	1730	3	9/9 [530x510]	Ventilado Forced air	IP 65	✓	724 522	684 934	4,96 3,60	C B	R 134 a R 290
AN 1605 T/F	AISI 304	55	1730	5	9/9 [530x510]	Ventilado Forced air	IP 65	✓	724 522	684 934	4,96 3,60	C B	R 134 a R 290
AN 1606 T/F	AISI 304	55	1730	6	9/9 [530x510]	Ventilado Forced air	IP 65	✓	724 522	684 934	4,96 3,60	C B	R 134 a R 290

SERIE AN 1600 L. SERIES



AN 1603 T/F

AN 1603 T/F

2081x700x2060 mm

Temp. -2°C/+8°C
C. Clima 5



AN 1605 T/F

2081x700x2060 mm

Temp. -2°C/+8°C
C. Clima 5



AN 1606 T/F

2081x700x2060 mm

Temp. -2°C/+8°C
C. Clima 5



OPCIONAL / OPTIONAL

- **Parrilla** / Wire shelf AN 1600 [502X02]
- **Juego de guías** / Slides [503X12; 503X17]
- **Barra carnicera** / Meat bar set [BCAN]
- **Cerradura** / Lock [506X209; 506X210]

3.

ARMARIO DE REFRIGERACIÓN EURONORMA 600X400 EURONORM 600x400 REACH IN REFRIGERATOR

3

Fotos no contractuales / Non contractual pictures



A 850 T/F PAST



MOD.

	 Acero inox Stainless Steel [EXT/INT]	 Espesor Thickness [MM]	 Capacidad Capacity [L]	 N° puertas Doors	 Parrillas/ Shelves/ Containers	 Sistema de frío Cooling System	 Control digital Digital control	 LED	 Potencia Power [W]	 Potencia frigorífica Cooling capacity [W A -10°C]	 Consumo Consumption [kWh/24h]	 Clase energética Energy class	 Refrigerante Refrigerant
A 850 T/F	AISI 304	55	500	1	3 parrillas/ 3 shelves [600x400]	Ventilado Forced air	IP 65	✓	540	298	2,12	d	R 134 a
									190	343	1,38	c	R 290
AP 850 T/F	AISI 304	55	500	1	7 contenedores 7 containers]	Ventilado Forced air	IP 65	✓	540	298	2,12	d	R 134 a
									190	343	1,38	c	R 290
AP 850 T/F PAST	AISI 304	55	500	1	18 Juegos de guías 18 Slides kit	Ventilado Forced air	IP 65	✓	540	298	2,12	d	R 134 a
									190	343	1,38	c	R 290

ARMARIOS REACH INS SERIE 850 SERIES



A 850 T/F



AP 850 T/F

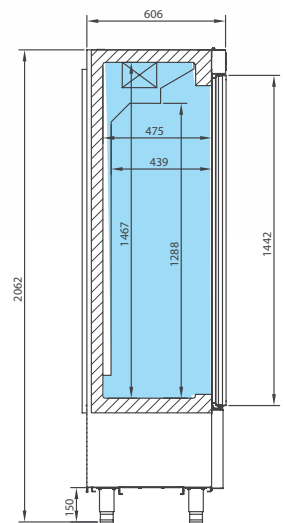

AP 850

A 850 T/F

800x605x2060 mm

Temp. -2°C/+8°C
C. Clima 5



AP 850 T/F

800x605x2060 mm

Temp. -2°C/+8°C
C. Clima 5



A 850 T/F PAST

800x605x2060 mm

Temp. -2°C/+8°C
C. Clima 5



OPCIONAL / OPTIONAL

- Parrilla / Wire shelf [502X10]
- Juego de guías / Slides [503X11]
- Bandeja 60x40 / Tray 60x40 [A850P41]
- Contenedor polipropileno / Polypropylene container [501X08]
- Ruedas / Casters [705X16=2; 705X17=2]

3.

ARMARIO DE REFRIGERACIÓN Y CONGELACIÓN GN 1/1

GN 1/1 REACH IN REFRIGERATOR AND FREEZER

3

Fotos no contractuales / Non contractual pictures



AGN 301

MOD.

	Acero inox Stainless Steel [EXT/INT]	Espesor Thickness [MM]	Capacidad Capacity [L]	N° puertas Doors	Parrillas/ J. Guías Shelves/ Slides	Sistema de frío Cooling System	Control digital Digital control	LED	Potencia Power [W]	Potencia frigorífica Cooling capacity [W A -10/ -30°C]	Consumo Consumption [kWh/24h]	Clase energética Energy class	Refrigerante Refrigerant
--	--	------------------------------	------------------------------	---------------------	--	-----------------------------------	------------------------------------	-----	--------------------------	--	-------------------------------------	----------------------------------	-----------------------------

AGN 301	AISI 304	55	325	1	3/3 [325x530]	Ventilado Forced air	IP 65	✓	400 187	298 343	2,20 1,40	E C	R 134 a R 290
AGN 602	AISI 304	55	745	2	6/6 [325x530]	Ventilado Forced air	IP 65	✓	540 372	464 690	2,76 1,85	D C	R 134 a R 290
AGN 301 BT	AISI 304	55	325	1	3/3 [325x530]	Ventilado Forced air	IP 65	✓	452	445	4,83	D	R 290
AGN 602 BT	AISI 304	55	745	2	6/6 [325x530]	Ventilado Forced air	IP 65	✓	671	644	9,22	D	R 290
AGN 602 MX	AISI 304	55	325+325	2	6/6 [325x530]	Ventilado Forced air	IP 65	✓	1170 852	298 445	7,03	-	R 134 a R 290

SERIE SLIM LINE 300/600 L. SERIES



AGN 602

OPCIONAL / OPTIONAL

- Parrilla / Wire shelf [502X12]
- Juego de guías / Slides [503X15; 503X20]
- Cerradura / Lock [506X209; 506X210]
- Ruedas / Casters [705X16=2; 705X17=2]

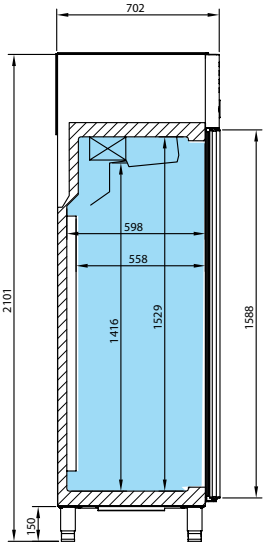

AGN 301

AGN 301

482x695x2100 mm

Temp. -2°C/+8°C
C. Clima 5



AGN 301 BT

482x695x2100 mm

Temp. -18°C
C. Clima 4



AGN 602

974x695x2100 mm

Temp. -2°C/+8°C
C. Clima 5



AGN 602 BT

974x695x2100 mm

Temp. -18°C
C. Clima 4



AGN 602 MX

974x695x2100 mm

Temp. -2°C/+8°C
Temp. -18°C
C. Clima 4



3.

ARMARIO DE REFRIGERACIÓN GN 1/1

GN 1/1 REACH IN REFRIGERATOR

3

Fotos no contractuales / Non contractual pictures



AGN 302

MOD.	Acero inox Stainless Steel [EXT/INT]	Espesor Thickness [MM]	Capacidad Capacity [L]	Nº puertas Doors	Parrillas/ J. Guías Shelves/ Slides	Sistema de frío Cooling System	Control digital Digital control	LED	Potencia Power [W]	Potencia frigorífica Cooling capacity [W A -10°C]	Consumo Consumption [kWh/24h]	Clase energética Energy class	Refrigerante Refrigerant
AGN 302	AISI 304	55	325	2	3/3 (325x530)	Ventilado Forced air	IP 65	✓	400	298	2,20	E	R 134 a
AGN 603	AISI 304	55	745	3	6/6 (325x530)	Ventilado Forced air	IP 65	✓	540	464	2,76	D	R 134 a
AGN 604	AISI 304	55	745	4	6/6 (325x530)	Ventilado Forced air	IP 65	✓	540	464	2,76	D	R 134 a

SERIE SLIM LINE 300/600 L. SERIES



AGN 604

AGN 302

482x695x2100 mm

Temp. -2°C/+8°C
C. Clima 5



AGN 603

974x695x2100 mm

Temp. -2°C/+8°C
C. Clima 5



AGN 604

974x695x2100 mm

Temp. -2°C/+8°C
C. Clima 5

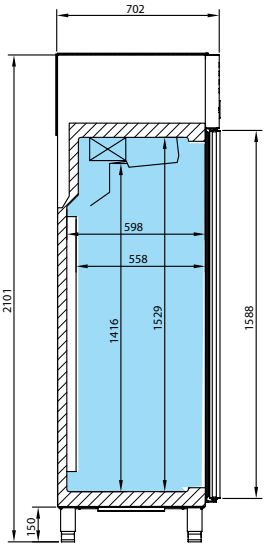

AGN 603

3.

ARMARIO DE REFRIGERACIÓN PUERTA DE CRISTAL GN 1/1 GLASS DOOR REACH IN REFRIGERATOR

3

Fotos no contractuales / Non contractual pictures



AGN 300 CR

MOD.

	Acero inox Stainless Steel (EXT/INT)	Espesor Thickness (MM)	Capacidad Capacity (L)	N° puertas Doors	Parrillas/J. Guías Shelves/ Slides	Sistema de frío Cooling System	Control digital Digital control	LED	Potencia Power (W)	Potencia frigorífica Cooling capacity (W A -10°C)	Consumo Consumption (kWh/24h)	Refrigerante Refrigerant
--	--	------------------------------	------------------------------	---------------------	---------------------------------------	-----------------------------------	------------------------------------	-----	--------------------------	---	-------------------------------------	-----------------------------

AGN 300 CR	AISI 304	55	325	1	4/4 [325x530]	Ventilado Forced air	IP 65	✓	298	372	3,30	R 134 a
AGN 600 CR	AISI 304	55	745	2	8/8 [325x530]	Ventilado Forced air	IP 65	✓	464	494	4,28	R 134 a

SERIE SLIM LINE AGN 300/600L SERIES



AGN 600 CR

AGN 300 CR

482x695x2100 mm

Temp. +2°C/+6°C
C. Clima 4



AGN 600 CR

974x695x2100 mm

Temp. +2°C/+6°C
C. Clima 4

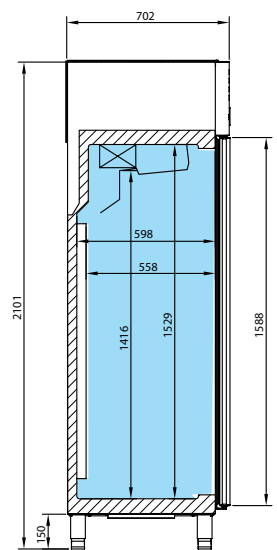

AGN 300 CR

OPCIONAL / OPTIONAL

- Parrilla doble tupida / Dense wire shelf [502X62]
- Parrilla inox / Stainless steel wire shelf [502X46]
- Juego de guías / Slides [GUIA503X15;GUIA503X20]
- Cerradura / Lock [506X60]

ARMARIO DE REFRIGERACIÓN Y CONGELACIÓN GN 2/1

GN 2/1 REFRIGERATOR AND FREEZER REACH IN

Fotos no contractuales / Non contractual pictures



Costados embutidos
Stamped inner sides

AGB 651

MOD.

Acero inox
Stainless Steel
(EXT/INT)

Espesor
Thickness
(MM)

Capacidad
Capacity
(L)

Nº puertas
Doors

Nº parrillas
No shelves

Sistema de frío
Cooling System

Control digital
Digital control

LED

Potencia
Power
(W)

Potencia frigorífica
Cooling capacity
(WA -10°C/-30°C)

Consumo
Consumption
(kWh/24h)

Clase energética
Energy class

Refrigerante
Refrigerant

MOD.	Acero inox Stainless Steel (EXT/INT)	Espesor Thickness (MM)	Capacidad Capacity (L)	Nº puertas Doors	Nº parrillas No shelves	Sistema de frío Cooling System	Control digital Digital control	LED	Potencia Power (W)	Potencia frigorífica Cooling capacity (WA -10°C/-30°C)	Consumo Consumption (kWh/24h)	Clase energética Energy class	Refrigerante Refrigerant
AGB 651	AISI 304	75	505	1	3[530x650]	Monoblock	IP65	✓	460	395	2,90	D	R 134 a
									371	690	1,41	C	R 290
AGB 1302	AISI 304	75	1120	2	6[530x650]	Monoblock	IP65	✓	600	568	3,55	D	R 134 a
									376	690	2,40	C	R 290
AGB 651 BT	AISI 304	75	505	1	3[530x650]	Monoblock	IP65	✓	631	644	7,12	D	R 290
AGB 1302 BT	AISI 304	75	1120	2	6[530x650]	Monoblock	IP65	✓	905	907	13,11	D	R 290

SERIE AGB 600/1300L. SERIES



Marco puerta calefactado
Heated door frame

Desescarche por gas caliente
Hot gas defrost system

Válvula de expansión termostática
Thermostatic expansion valve

AGB 1302 BT

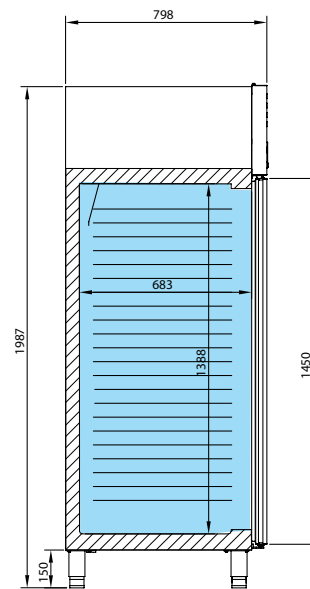

AGB 651

AGB 651

687x794x1989 mm

Temp. -2°C/+8°C
C. Clima. 5

AGB 651 BT

687x794x1989 mm

Temp. -18°C
C. Clima. 4

AGB 1302

1385x794x1989 mm

Temp. -2°C/+8°C
C. Clima. 5

AGB 1302 BT

1385x794x1989 mm

Temp. -18°C
C. Clima. 4



OPCIONAL / OPTIONAL

- Parrilla / Wire shelf [502X91]
- Guía adicional [AGB 1302] / Additional slide [AGB1302]/ Slides [503X39]
- Ruedas / Casters [705X16=2; 705X17=2]

ARMARIO DE REFRIGERACIÓN GN 2/1

REFRIGERATOR REACH IN

Clase energética A

Energy class A

Fotos no contractuales / Non contractual pictures



Motoventiladores EC
EC motorfans



Refrigerante Natural R 600 a
Natural Refrigerant R 600 a



Compresor de velocidad variable
Variable-capacity compressor



Válvula de expansión electrónica
Electronic expansion valve

Clase energética Energy efficiency class	Coste energía* Energy cost (€/year)
A	68
B	103
C	149
D	225
E	256
F	286
G	351
Ahorro total comparando clase A y G Total saving comparing class A & G	283 €/year

*Coste estimado de 0,20 €/kWh
Estimated energy cost of 0,20 €/kWh

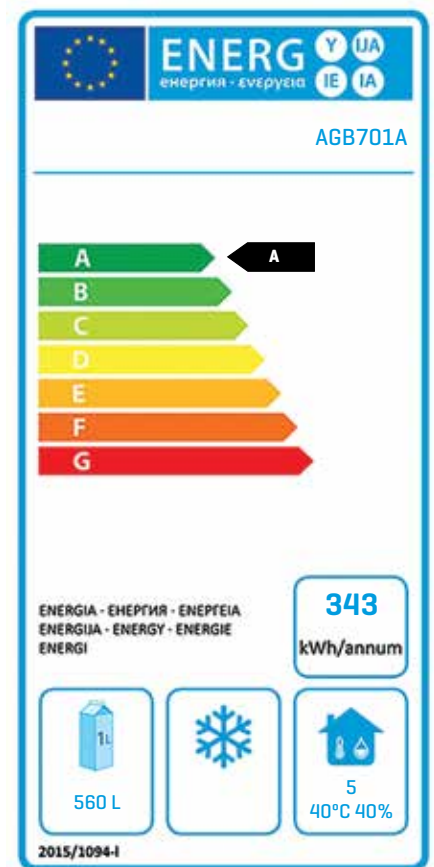

MOD.

Acero inox
Stainless Steel
(EXT/INT)

Espesor
Thickness
(MM)

Capacidad
Capacity
(L)

Nº puertas
Doors

Nº parrillas
No shelves

Sistema de frío
Cooling System

Control digital
Digital control

LED

Potencia
Power
(W)

Potencia frigorífica
Cooling capacity
(W A -10°C)

Consumo
Consumption
(kWh/24h)

Clase energética
Energy class

Refrigerante
Refrigerant

AGB 701 A

AISI 304

75

560

1

3
(530x650)

Monoblock

IP65

✓

110

334

0,94

A

R 600 a

SERIE AGB A 700 L. SERIES



**80%
DE AHORRO
EN CONSUMO!**
80% ENERGY
SAVING!

AGB 701 A

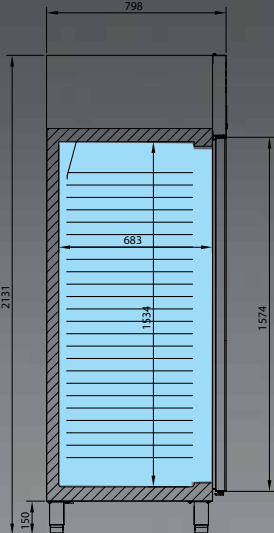

AGB 701

AGB 701 A

687x794x2130 mm

Temp. -2°C/+8°C
C. Clima. 5



3.

ARMARIO DE REFRIGERACIÓN Y CONGELACIÓN GN 2/1

REFRIGERATOR AND FREEZER REACH IN

Costados embutidos
Stamped inner sides

Parrillas reforzadas
Reinforced wire selves

AGB 701



MOD.

	Acero inox Stainless Steel (EXT/INT)	Espesor Thickness (MM)	Capacidad Capacity (L)	N° puertas Doors	N° parrillas No shelves	Sistema de frío Cooling System	Control digital Digital control	LED	Potencia Power (W)	Potencia frigorífica Cooling capacity (W A -10°C/-30°C)	Consumo Consumption (kWh/24h)	Clase energética Energy class	Refrigerante Refrigerant
--	--	------------------------------	------------------------------	---------------------	----------------------------	-----------------------------------	------------------------------------	-----	--------------------------	---	-------------------------------------	----------------------------------	-----------------------------

AGB 701	AISI 304	75	560	1	3 (530x650)	Monoblock	IP65	✓	491	395	3,25	E	R 134 a
									371	690	1,54	C	R 290
AGB 1402	AISI 304	75	1240	2	6 (530x650)	Monoblock	IP65	✓	610	568	3,61	C	R 134 a
									376	690	2,55	B	R 290
AGB 701 BT	AISI 304	75	560	1	3 (530x650)	Monoblock	IP65	✓	631	644	7,80	D	R 290
AGB 1402 BT	AISI 304	75	1240	2	6 (530x650)	Monoblock	IP65	✓	905	907	13,92	D	R 290

SERIE AGB 700/1400 L. SERIES



AGB 1402 BT

AGB 701

687x794x2130 mm

Temp. -2°C/+8°C
C. Clima. 5

AGB 701 BT

687x794x2130 mm

Temp. -18°C
C. Clima. 4

AGB 1402

1385x794x2130 mm

Temp. -2°C/+8°C
C. Clima. 5

AGB 1402 BT

1385x794x2130 mm

Temp. -18°C
C. Clima. 4



OPCIONAL / OPTIONAL

- Parrilla / Wire shelf [502X91]
- Guía adicional [AGB 1402] / Additional slide [AGB1402] / Slides [503X39]
- Ruedas / Casters [705X16=2; 705X17=2]
- Gas R 290

3.

ARMARIO DE REFRIGERACIÓN Y CONGELACIÓN GN 2/1 GN 2/1 REACH IN REFRIGERATOR AND FREEZER

3

Fotos no contractuales / Non contractual pictures



AGB 702

MOD.

	Acero inox Stainless Steel (EXT/INT)	Espesor Thickness (MM)	Capacidad Capacity (L)	N° puertas Doors	N° parrillas No shelves	Sistema de frío Cooling System	Control digital Digital control	LED	Potencia Power (W)	Potencia frigorífica Cooling capacity (W A -10°C)	Consumo Consumption (kWh/24h)	Clase energética Energy class	Refrigerante Refrigerant
AGB 702	AISI 304	75	560	2	3 [530x650]	Monoblock	IP65	✓	491	395	3,25	E	R 134 a
									371	690	1,54	C	R 290
AGB 702 BT	AISI 304	75	560	2	3 [530x650]	Monoblock	IP65	✓	631	644	7,8	D	R 290
AGB 1403	AISI 304	75	1240	3	6 [530x650]	Monoblock	IP65	✓	610	568	3,61	C	R 134 a
									376	690	2,55	B	R 290
AGB 1404	AISI 304	75	1240	4	6 [530x650]	Monoblock	IP65	✓	610	568	3,61	C	R 134 a
									376	690	2,55	B	R 290

SERIE AGB 700/1400 L. SERIES



AGB 1404

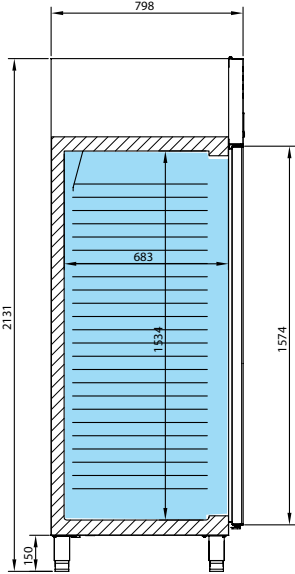

AGB 702

687x794x2130 mm

Temp. -2°/+8°C
C. Clima. 5

AGB 702 BT

687x794x2130 mm

Temp. -18°C
C. Clima. 4

AGB 1403

1385x794x2130 mm

Temp. -2°/+8°C
C. Clima. 5

AGB 1404

1385x794x2130 mm

Temp. -2°/+8°C
C. Clima. 5

OPCIONAL / OPTIONAL

- Parrilla / Wire shelf [502X91]
- Guía adicional [AGB 1402]/ Additional slide [AGB1402]/ Slides [503X39]
- Ruedas / Casters [705X16=2; 705X17=2]
- Gas R 290



3.

ARMARIO MIXTO GN 2/1

GN 2/1 DUAL TEMP REACH IN 700/1400 L.













3

Fotos no contractuales / Non contractual pictures



AGN 702 MX

MOD.

-  Acero inox
Stainless Steel
[EXT/INT]
-  Espesor
Thickness
[MM]
-  Capacidad
Capacity
[L]
-  N° puertas
Doors
-  N° parrillas
No shelves
-  Sistema de frío
Cooling System
-  Control digital
Digital control
-  LED
-  Potencia
Power
[W]
-  Potencia frigorífica
Cooling capacity
[W A -30°C]
-  Consumo
Consumption
[kWh/24h]
-  Refrigerante
Refrigerant

AGN 702 MX	AISI 304	75	260/260	2	3 [530x650]	Ventilado Forced air	IP65	✓	807	298/445	7,03	R 134 a R-290
AGB 1402 MX	AISI 304	75	560/560	2	6 [530x650]	Monoblock	IP65	✓	1122	395/644	11.05	R 134 a R-290

SERIE AGB 700/1400L. SERIES



AGB 1402 MX

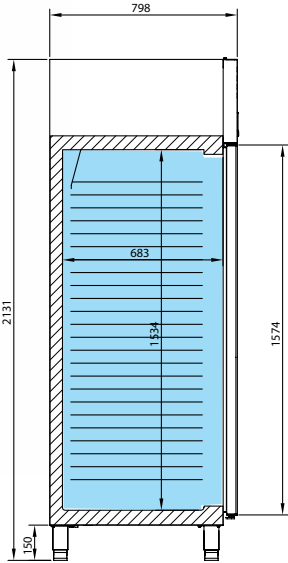

AGN 702 MX

AGN 702 MX

687x794x2130 mm

Temp. -2°C/+8°C | Temp. -18°C
C. Clima. 4

AGB 1402 MX

1385x794x2130 mm

Temp. -2°C/+8°C | Temp. -18°C
C. Clima. 4



OPCIONAL / OPTIONAL

- Parrilla / Wire shelf [502X91]
- Guía adicional [AGB 1402]/ Additional slide [AGB1402]/ Slides [503X39]
- Ruedas / Casters [705X16=2; 705X17=2]

ARMARIO DE REFRIGERACIÓN Y CONGELACIÓN PUERTAS DE CRISTAL

GN 2/1 GLASS DOOR REACH IN REFRIGERATOR AND FREEZER

Fotos no contractuales / Non contractual pictures



Triple cristal templado bajo emisivo
Tempered and low-e triple pane glass.
[4-12-3-12-4]

AGB 701 BTCR

MOD.

 Acero inox
Stainless Steel
[EXT/INT]

 Espesor
Thickness
[MM]

 Capacidad
Capacity
[L]

 N° puertas
Doors

 N° parrillas
No shelves

 Sistema de frío
Cooling System

 Control digital
Digital control

 LED

 Potencia
Power
[W]

 Potencia frigorífica
Cooling capacity
[WA-10°C]

 Consumo
Consumption
[kWh/24h]

 Refrigerante
Refrigerant

MOD.	Acero inox Stainless Steel [EXT/INT]	Espesor Thickness [MM]	Capacidad Capacity [L]	N° puertas Doors	N° parrillas No shelves	Sistema de frío Cooling System	Control digital Digital control	LED	Potencia Power [W]	Potencia frigorífica Cooling capacity [WA-10°C]	Consumo Consumption [kWh/24h]	Refrigerante Refrigerant
AGB 701 CR	AISI 304	75	560	1	4 [530x650]	Monoblock	IP65	✓	497	464	5,03	R 134 a
AGB 1402 CR	AISI 304	75	1240	2	8 [530x650]	Monoblock	IP65	✓	1034	684	5,77	R 134 a
AGB 701 BT CR	AISI 304	75	560	1	4 [530x650]	Monoblock	IP65	✓	890	907	11,70	R-290
AGN 1402 BT CR	AISI 304	75	1225	2	8 [530x650]	Ventilado Forced air	IP65	✓	1530	1814	19,04	R-290

SERIE AGB 700/1400L. SERIES



Doble cristal templado bajo emisivo
Tempered and low-e double pane glass.
4-27-4

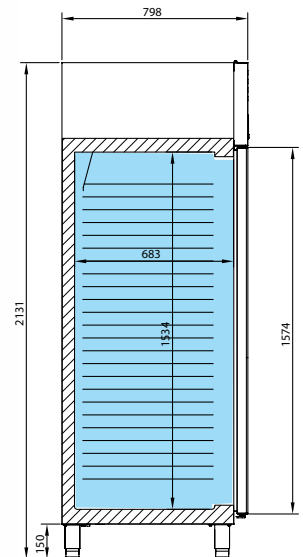

AGB 701 CR

AGN 1402 CR

AGB 701 CR

687x794x2130 mm

Temp. -2°C/+6°C
C. Clima. 4



AGB 701 BT CR

687x794x2130 mm

Temp. -18°C.
C. Clima. 4



AGB 1402 CR

1385x794x2130 mm

Temp. -2°C/+6°C
C. Clima. 4



AGN 1402BT CR

1385x794x2130 mm

Temp. -18°C
C. Clima. 4



OPCIONAL / OPTIONAL

- Parrilla / Wire shelf [502X91]
- Guía adicional [AGB 1402]/ Additional slide [AGB1402]/ Slides [503X39]
- Ruedas / Casters [705X16=2; 705X17=2]
- Iluminación LED RGB cambio de color/ LED lighting RGB colour changing

3.

ARMARIO DE REFRIGERACIÓN PESCADO 600X400 FISH REFRIGERATOR REACH IN

3











Fotos no contractuales / Non contractual pictures



AGB 701 PESC 



MOD.

	 Acero inox Stainless Steel [EXT/INT]	 Espesor Thickness [MM]	 Capacidad Capacity [L]	 N° puertas Doors	 N° contenedores Containers	 Sistema de frío Cooling System	 Control digital Digital control	 LED	 Potencia Power [W]	 Potencia frigorífica Cooling capacity [WA -10°C]	 Consumo Consumption [kWh/24h]	 Clase energética Energy class	 Refrigerante Refrigerant
--	--	--	--	---	---	---	--	---	---	--	---	--	---

AGB 701 PESC	AISI 304	75	560	1	7	Monoblock	IP65	✓	491	395	3,25	E	R 134 a
									371	690	1,54	C	R 290
AGB 1402 PESC	AISI 304	75	1240	2	14	Monoblock	IP65	✓	610	568	3,61	C	R 134 a
									376	690	2,55	B	R 290

SERIE AGB 700/1400L. SERIES



AGB 1402 PESC

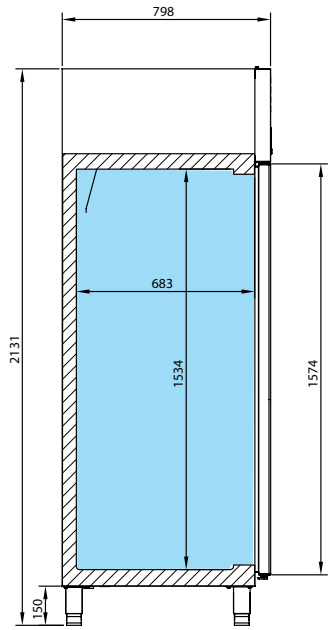

AGB

AGB 701 PESC

687x794x2130 mm

Temp. -2°C/+2°C
C. Clima. 5

AGB 1402 PESC

1385x794x2130 mm

Temp. -2°C/+2°C
C. Clima. 5



OPCIONAL / OPTIONAL

- Contenedor polipropileno / Polypropylene container [501X08]
- Juego de guías / Slides [503X02; 503X03]

3.

ARMARIO DE REFRIGERACIÓN EURONORM 600X400 PASTELERÍA EURONORM 600X400 PASTRY REACH IN REFRIGERATOR

3

Fotos no contractuales / Non contractual pictures



AGB 701 PAST



MOD.

	Acero inox Stainless Steel [EXT/INT]	Espesor Thickness [MM]	Capacidad Capacity [L]	N° puertas Doors	Bandejas/ J. guías Trays/ Slides	Sistema de frío Cooling System	Control digital Digital control	LED	Potencia Power [W]	Potencia frigorífica Cooling capacity [W A -10°C/-30°C]	Consumo Consumption [kWh/24h]	Clase energética Energy class	Refrigerante Refrigerant
--	--	------------------------------	------------------------------	---------------------	--	-----------------------------------	------------------------------------	-----	--------------------------	---	-------------------------------------	----------------------------------	-----------------------------

AGB 701 PAST	AISI 304	75	560	1	0/18	Monoblock	IP65	✓	491	395	3,25	E	R 134 a
									371	690	1,54	C	R 290
AGB 1402 PAST	AISI 304	75	1240	2	0/36	Monoblock	IP65	✓	610	568	3,61	C	R 134 a
									376	690	2,55	B	R 290
AGB 701 BT PAST	AISI 304	75	560	1	0/18	Monoblock	IP65	✓	473	690	7,80	D	R 290
AGB 1402 BT PAST	AISI 304	75	1240	2	0/36	Monoblock	IP65	✓	905	907	13,92	D	R 290

SERIE AGB 700/1400L. SERIES



ARMARIOS
REACH INS



AGB 1402 PAST

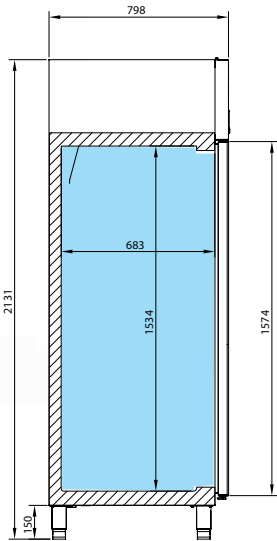

AGB 701 PAST

687x794x2130 mm

Temp. -2°C/+8°C
C. Clima. 5



AGB 701 BT PAST

687x794x2130 mm

Temp. -18°C
C. Clima. 4



AGB 1402 PAST

1385x794x2130 mm

Temp. -2°C/+8°C
C. Clima. 5



AGB 1402 BT PAST

1385x794x2130 mm

Temp. -18°C
C. Clima. 4



OPCIONAL / OPTIONAL

- Bandeja 600x400 / Tray 600x400 [A850P41]
- Juego de guías / Slides [503X02; 503X03]
- Cerradura / Lock [506X120; 506X121]

3.

ARMARIO DE REFRIGERACIÓN Y CONGELACIÓN 800X600 HELADERÍA PASTELERÍA EURONORMA PASTRY ICE CREAM 800X600 REACH IN REFRIGE- RATOR AND FREEZER

3

Fotos no contractuales / Non contractual pictures



AGB 901

MOD.

- Acero inox
Stainless Steel
(EXT/INT)
- Espesor
Thickness
(MM)
- Capacidad
Capacity
(L)
- N° puertas
Doors
- N° parrillas
No shelves
- Sistema de frío
Cooling System
- Control digital
Digital control
- LED
- Potencia
Power
(W)
- Potencia frigorífica
Cooling capacity
(WA -10°C/-30°C)
- Consumo
Consumption
(kWh/24h)
- Clase energética
Energy class
- Refrigerante
Refrigerant

MOD.	Acero inox Stainless Steel (EXT/INT)	Espesor Thickness (MM)	Capacidad Capacity (L)	N° puertas Doors	N° parrillas No shelves	Sistema de frío Cooling System	Control digital Digital control	LED	Potencia Power (W)	Potencia frigorífica Cooling capacity (WA -10°C/-30°C)	Consumo Consumption (kWh/24h)	Clase energética Energy class	Refrigerante Refrigerant
AGB 901	AISI 304	75	785	1	6 (600x800)	Monoblock	IP65	✓	520	464	3,44	D	R-134a
									371	690	1,60	B	R 290
AGB 901 BT	AISI 304	75	785	1	6 (600x800)	Monoblock	IP65	✓	815	907	7,95	D	R 290

ARMARIOS REACH INS

SERIE AGB 900L. SERIES



Motoventiladores EC
EC motorfans

Marco de puerta calefactado
Heated door frame

Desescarche por gas caliente
Hot gas defrost system

Válvula de expansión termostática
Thermostatic expansion valve

Capacidad 54 cubetas de helado de 5 L. (BT no incluido)
Capacity 54 ice-cream 5 L. trays
[BT not included]

AGB 901 BT

AGB 901

756x960x2130 mm

Temp. -2°C/+8°C
C. Clima. 5

AGB 901 BT

756x960x2130 mm

Temp. -22°C/-25°C
C. Clima. 4

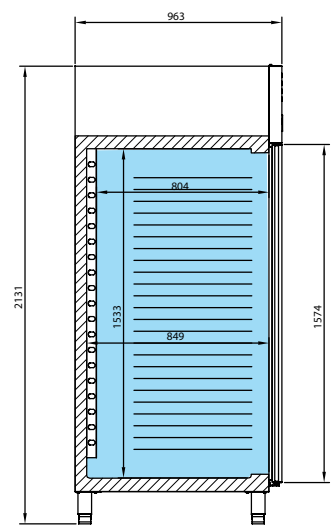

AGB 901



OPCIONAL / OPTIONAL

- **Bandeja** / Tray 60x40 [850 P41]
- **Parrilla** / Wire shelves 80x60 [502X94]
- **Bandeja helados 5 L.** / 5 L. ice cream tray [501X32]

3.

ARMARIO DE FERMENTACIÓN RETARDER PROOFER CABINET

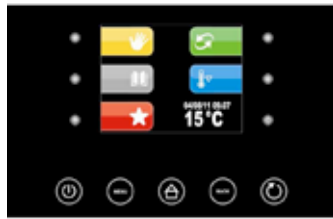

Fotos no contractuales / Non contractual pictures

Nuevo control táctil con programas automáticos de 7 fases (bloqueo-refrigeración-activación-fermentación-mantenimiento)

New touch-screen control with 7 phases automatic programs (block-refrigeration-activation-proving-maintenance).

Posibilidad de memorizar hasta 10 programas

Possibility to memorize up to 10 programs.



Humidificador / Humidifier

Resistencia aleada en acero inox / Stainless steel finned heater

FC 900 BT

FC 900 BT

756x960x2130 mm

Temp. -18°C/+35°C
C.Clima 4



OPCIONAL / OPTIONAL

- Parrilla / Wire shelves 80x60 [502X57]
- Parrilla / Wire shelves 60x40 [502X26]
- Sonda Trococónica / Conical Probe [308X70]

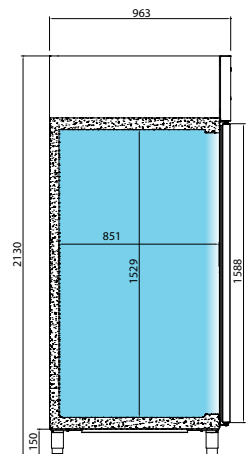

FC 900 BT

MOD.

Acero inox
Stainless Steel
[EXT/INT]

Espesor
Thickness
[MM]

Capacidad
Capacity
[L]

Nº puertas
Doors

Nº parrillas
No shelves

Sistema de frío
Cooling System

Control digital
Digital control

Potencia
Power
[W]

Potencia frigorífica
Cooling capacity
[W A -30°C]

Potencia calor
Heat power
[W]

Refrigerante
Refrigerant

FC 900 BT	AISI 304	75	785	1	0	Monoblock	IP65	2012	1105	750	R 452 A
-----------	----------	----	-----	---	---	-----------	------	------	------	-----	---------

ARMARIO CATERING REFRIGERACIÓN Y CONGELACIÓN 600 L. CATERING REACH IN REFRIGERATOR AND FREEZER 600 L.



Contenedor 500 x 300 mm de serie
Container 500 x 300 mm standard



Contenedor 600 x 400 mm de serie
Container 600 x 400 mm standard

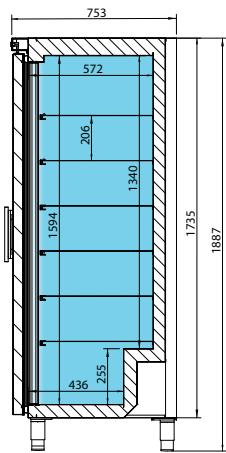

AC 600 BT

AC 600 R

750x752x1887 mm

Temp. 0°C/+8°C
C. Clima. 4

AC 600 BT

750x752x1887 mm

Temp. -18°C/-25°C
C. Clima. 4



OPCIONAL / OPTIONAL

- Parrilla/Wire shelf [502X76]
- Ruedas / Casters [705X16; 705X17 =2]
- Contenedor / Container 500x300x180mm [501X44]
- Contenedor / Container 600x400x220mm [501X45]

AC 600 BT

MOD.

Acero Steel [EXT/MT]

Espesor Thickness [MM]

Capacidad Capacity [L]

Nº puertas Doors

Nº cubetas / No Pans
Nº parrillas / guías
No shelves / Slides

Sistema de frío Cold System

Control digital Digital control

LED

Potencia Power [W]

Consumo Consumption [kWh/24h]

Clase energética Energy class

Refrigerante Refrigerant

Model	Acero Steel [EXT/MT]	Espesor Thickness [MM]	Capacidad Capacity [L]	Nº puertas Doors	Nº cubetas / No Pans Nº parrillas / guías No shelves / Slides	Sistema de frío Cold System	Control digital Digital control	LED	Potencia Power [W]	Consumo Consumption [kWh/24h]	Clase energética Energy class	Refrigerante Refrigerant
AC 600 R	AISI 430	75	542	1	3 parrillas / shelves [600X500]	Ventilado Forzed Air	IP65	✓	270	1,45	C	R 134 a
AC 600 BT	AISI 430	75	542	1	12+1 contenedores / containers	Estático Static	IP65	✓	460	-	-	R 134 a

3.

ARMARIO PARA CARROS GN 2/1, 600x400, 650x450, 800x600, 1300/2700 L. GN 2/1, 600x400, 650x450, 800x600, 1300/2700 L. ROLL-IN









3

Fotos no contractuales / Non contractual pictures



RIC2 P BT

Rampa incluida [BT]
Ramp included [BT]

MOD.	 Acero inox Stainless Steel [EXT/INT]	 Espesor Thickness [MM]	 Capacidad Capacity [L]	 Nº puertas Doors	 Sistema de frío Cooling System	 Control digital Digital control	 Potencia Power [W]	 Potencia frigorífica Cooling capacity [W A -10°C/-30°C]	 Refrigerante Refrigerant
RIC1P	AISI 304	80	1281	1	Monoblock	IP65	499	464	R 134 a
RIC2P	AISI 304	80	2796	2	Monoblock	IP65	1034	684	R 134 a
RIC1PTH	AISI 304	80	1281	2	Monoblock	IP65	497	464	R 134 a
RIC1PBT	AISI 304	80	1281	1	Monoblock	IP65	910	739	R 452 A
RIC2PBT	AISI 304	80	2727	2	Monoblock	IP65	1390	1161	R 452 A

SERIE RIC SERIES

CAPACIDAD POR PUERTA = CARRO GN 2/1, 600x400, 650x450, 800x600



RIC1P

RIC1P

940x1075x2360 mm

Temp. 0°C/+8°C
C. Clima. 5



RIC1PBT

940x1075x2360 mm

Temp. -18°C
C. Clima. 4



RIC2P

1820x1075x2360 mm

Temp. 0°C/+8°C
C. Clima. 5



RIC2PBT

1820x1075x2360 mm

Temp. -18°C
C. Clima. 4



RIC1PTH

Pasante /Pass-throw

940x1075x2360 mm

Temp. 0°C/+8°C
C. Clima. 5

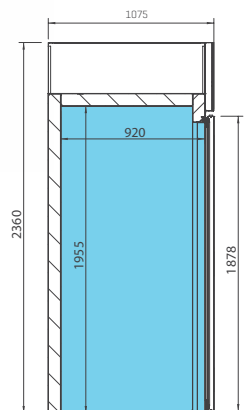

RIC



Empresa Homologada por la
Dirección General del Patrimonio del Estado

mobiliar@mobiliar.es
www.mobiliar.es
902 365 064



CENTRAL

C/ La Fragua, 5 • Edificio Mobiliar • Pl. "Los Rosales"
Tel.: 916 656 230 • Fax: 916 641 506
28933 Móstoles (Madrid)

DELEGACIÓN

C/ Pere el Ceremonios, 3 • Nave 2 • Pl. "Masía de Espí"
Tel.: 961 534 064 • Fax: 961 537 790
46930 Quart de Poblet (Valencia)

FÁBRICA

Avda. de las Retamas, s/n • Pl. "Monte Boyal"
Tel.: 918 171 744 • Fax: 918 170 952
45950 Casarrubios del Monte (Toledo)